

# Assisi Hospice

*Life affirming care that ensures comfort & dignity*

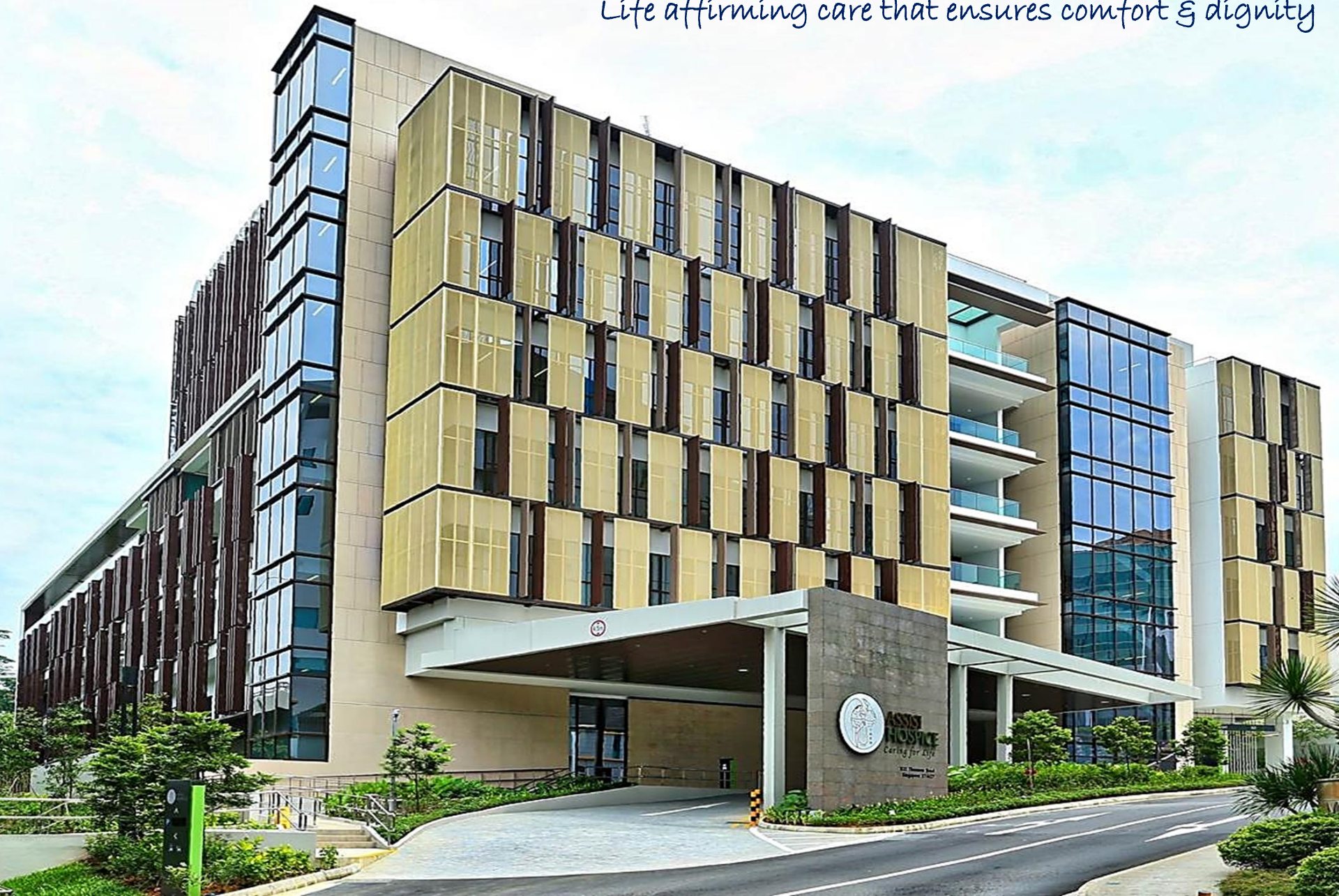



# Early Days – To Serve the Community

FMDM – Franciscan Missionaries of the Divine Motherhood: Created Assisi



**FMDM Sisters provided Tuberculosis Nursing**



“China Pioneers” Sisters Camillus, Angela & Baptista arrived in Singapore in 1949 upon the invitation of Bishop Olcomendy to care for TB patients

**Giving to the community**



**Set-up Nursing & Education for Leprosy**



**Christmas celebration, Trafalgar Home 1951  
Previously known as ‘The Leper Camp’**

# Assisi Hospice – We are a Mission with a Hospice



**1969**  
**Khoo Block**  
Chronically ill patients

**1986**  
**Assisi Home**  
Started Respite Care

**1988**  
**Assisi Home**  
Started Hospice Care



**1992**  
**Assisi Home & Hospice**  
Sisters vacated convent. Refurbished to provide facilities for comprehensive Hospice & Respite Care



Opening Ceremony @  
refurbished Convent  
April 1993

**2007**  
**Assisi Hospice**  
1 Jan 2007 renamed as  
Assisi Hospice



**2017 January**  
**Assisi Hospice**  
New building  
Hospice Care for adults and children with life limiting illnesses.



# Palliative Care as an Approach to Healthcare



Palliative Care is an approach that improves the quality of life of patients and families facing problems associated with life threatening illnesses:

- The patient & family is the unit of care
- Develop a caring community around the patient and family
- Palliative care to be offered early in the course of illness with other treatment
- **Palliative care is Life Affirming – Live fully in Comfort and Dignity**
- Human growth and development is a lifelong process – families continue to grow during the patient's last phase in life
- Complex and interacting needs of patients - Care is delivered by a multiprofessional team with an interdisciplinary workstyle.





# The Care Team for Patients & Families – A Community of Care

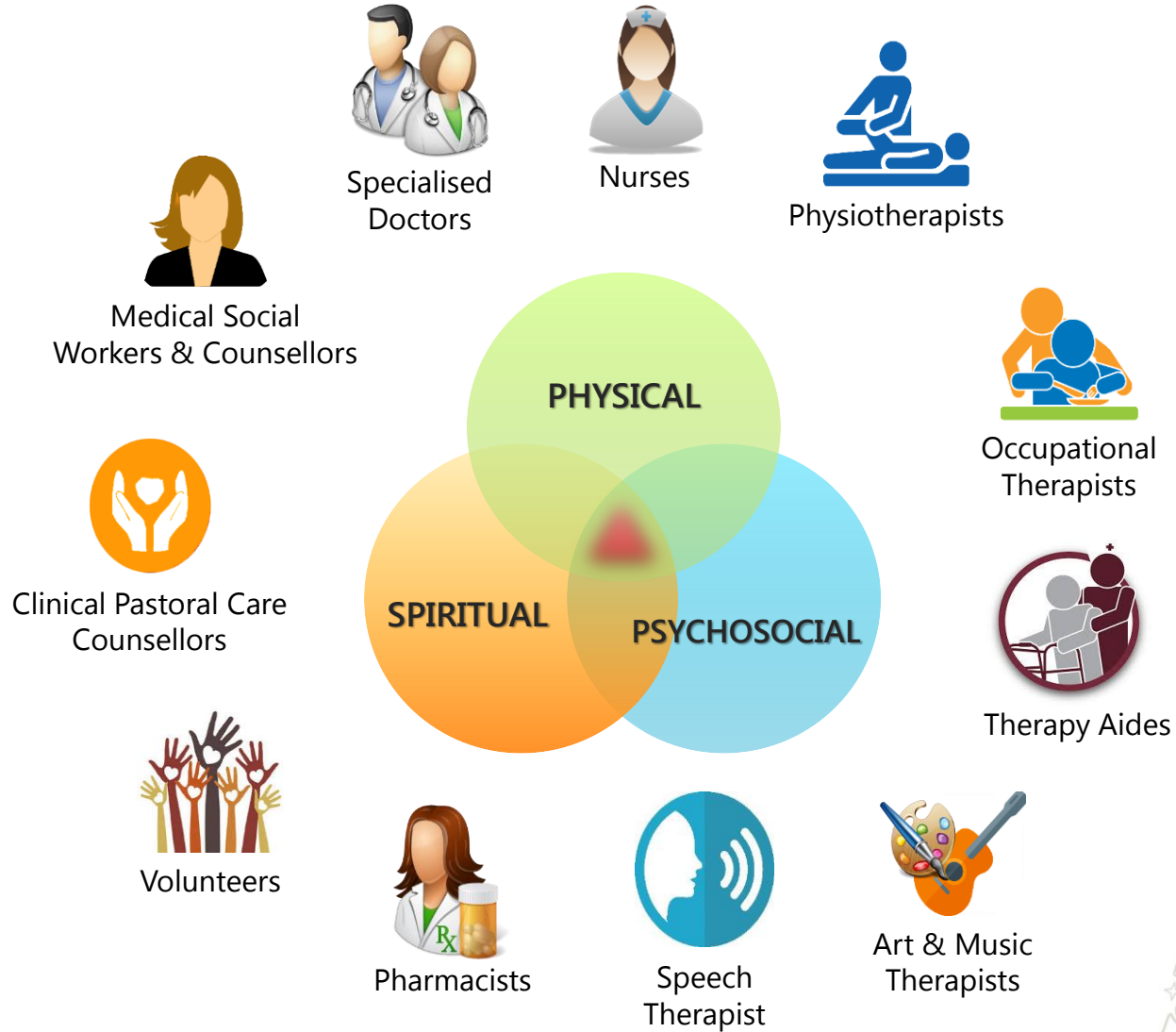

# Our Philosophy of Care – Living in Comfort and with Dignity

Supporting our patients as best as we can



## Home Care



## Inpatient Care



## Day Care





# Our Facilities – Philosophy of Care in Design

## Nature & Greenery – Life Giving Environment



Balcony for all rooms



Garden for all



Koi pond



Herb garden  
Patients harvesting



Butterfly garden



Playground



Bridge to roof garden



Courtyard



# Our Facilities – Philosophy of Care in Design

## Comfort & Dignity



Comfortable rooms



Dining



Pantry



Communal spaces



CHAPEL



Cosy corners



Family conference rooms





# Our Space – Philosophy of Care

Living well. Joy.

**A PRIVATE CONCERT**  
Featuring **KATHERINE YUE**  
Accompanied by Tammy Lim

MONDAY, 14 MAY  
2.30PM  
ASSISI HOSPICE  
LEVEL 2  
DINING HALL



Young & Old. One community



Play



Music . Art . Makan



Music for everyone

Every One Matters.  
Every Moment Counts



Erhu Master. Our Patient. Concert



This is what I like



Fuzzy friends



# Commitment to Supporting Our Staff

How patients & families experience our care is directly a function of how our staff experience their life at work.



## Commitment to Training & Development, building a supportive community at work



**Assisi Celebrates**  
(Monthly)



**Fortnightly Staff Activities**



**Mission Engagement**  
(Monthly)



**Staff Celebrations**  
(Often!)



**CPC Counselling**



**Mission Formation**  
**Gift of LOVE**



**5 Moments of Care**  
(For Staff, all Patients)



**Shared Interests**  
Writing the Assisi Song. Holding Concerts for Patients



**Interfaith Memorial Service**  
(All Patients' Families)



**Bringing Art to All**  
Patients . Staff . Volunteers



**MDM & Mortality Reviews**  
(All Patients)



**Just Getting Together!**





# Living in comfort and with dignity – what we all want

The ministry of Assisi Hospice is to reach out to LOVE & CARE for those who are vulnerable and sick.







Every One Matters.  
Every Moment Counts.